

No.	Item	Symbol	Unit	Specification	No.	Item	Symbol	Unit	Specification
1	Drive	-	-	3 ϕ 220VAC	13	Rotor Inertia	J-M	kg-cm ²	0.42 \pm 10%
2	Cooling Method	-	-	Totally Enclosed	14	Rated Power Rate	Q-R	Kw/s	9.75
3	Exciting Method	-	-	Permanent Magnet	15	Resistance	Ra	Ω	6.4 \pm 10%/2 ϕ
4	Resolution	-	-	23 bit-INC	16	Inductance	L	mH	16.2 \pm 10% / 2 ϕ
5	Rated Output	P-R	W	200	17	Mech. Time Constant	Tm	ms	1.89 \pm 10%
6	Rated Torque	T-R	N-m	0.64	18	Elect. Time Constant	Te	ms	2.53 \pm 10%
7	Max. Torque	T-max	N-m	1.91	19	Insulation Class	-	-	Class F
8	Rated Speed	N-R	rpm	3000	20	Operation Temp.	T	$^{\circ}$ C	0~40
9	Rated Current	I-R	A	1.6	21	Operation Humd.	RH	%	<80
10	Max. Current	I-max	A	4.8	22	Storage Temp.	T	$^{\circ}$ C	-20 $^{\circ}$ ~60 $^{\circ}$
11	Torque Constant	Kt	N-m/A	0.46	23	Storage Humd.	RH	%	<80
12	Voltage constant	Ke	V/Krpm	28 \pm 10%	24	Weight	W	kgw	1.1

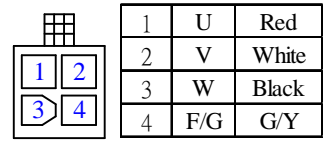

Motor Wiring

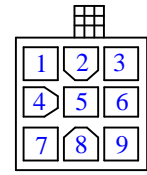

1	Vcc	White
2	GND	Black
3	-	-
4	-	-
5	SD+	Blue
6	SD-	Purple
7	-	-
8	-	-
9	FG	Shield

Encoder Wiring

AC SERVO MOTOR
 Model: JSMA-PBC02A3K
 Pr: 0.2 KW ; Nr: 3000 rpm
 Ir: 1.6 A , Tr: 0.64 N-m
 NO.
TECO ELECTRIC & MACHINERY CO., LTD.
 MADE IN TAIWAN

Notes:
 1. Motor to be IP67
 (excluding the shaft opening & connectors)
 2. Encoder shield wire to be grounded to the motor.

PIN:AMP 170360-1
 HOUSING:AMP 172167-1

PIN:AMP 770835-1
 HOUSING:AMP 172169-1

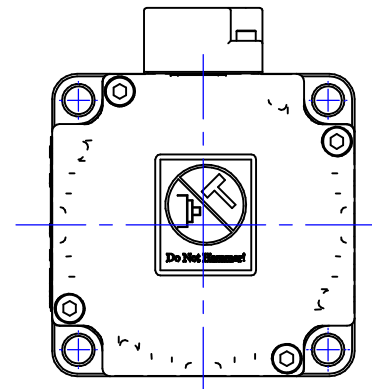
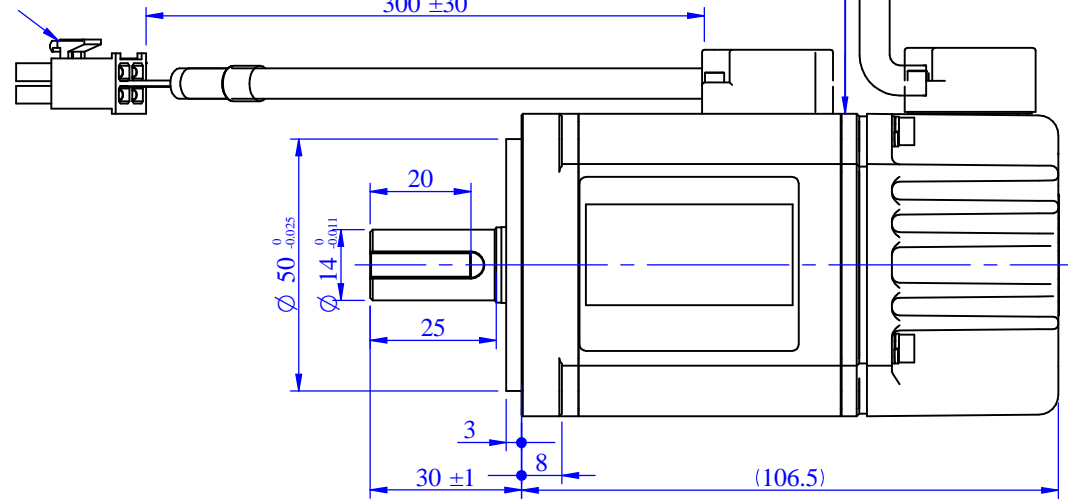
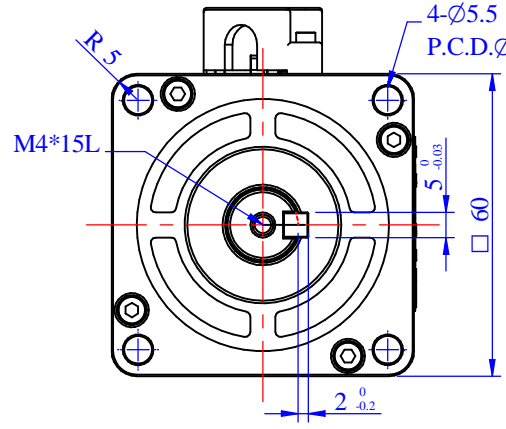

STANDARD TOLERANCE	
X	\pm 0.5
.X	\pm 0.2
.XX	\pm 0.05
ANGLE	\pm 30'

MATERIAL	REV	DESCRIPTION	SIGNATURE	DATE

APVD	SCALE	2/3	UNIT	mm	NAME	SERVO MOTOR OUTLINE DRAWING			
CHKD	3RD .A.P		TITLE	JSMA-PBC02A3K					
CHKD	Leon		03-22-'16			TECO ELECTRO DEVICES CO., LTD.	Dept. Design	DWG.NO.	D01E06201C3NZ3D01
DWN									